

Trailed Sprayers



# METRIS 2

3202 / 4102

[www.kuhn.com](http://www.kuhn.com)



be strong, be **KUHN**



METRIS

3202

4102

# INCREASE YOUR WORK OUTPUT

## IT IS NOW POSSIBLE TO COMPLETE 100 HA BEFORE MIDDAY!

METRIS 2 sprayers allow you to act quickly, when conditions are most favourable! METRIS 2 sprayers provide a high work rate:

- flexibility, with 4 levels suspension
- injected polyester tank, easier to rinse
- ergonomic setting up, for work in complete safety!

## QUALITY IS YOUR WATCHWORD

The accuracy of METRIS 2 sprayers allows you to protect your crops durably and sustainably. With top-quality finishing, METRIS 2 sprayers provide you with all the equipment you need.

## KUHN trailed sprayer solutions



	Tank volume (L)	Working width (m)
<b>METRIS 3202</b>	3200 L	18 to 36 m
<b>METRIS 4102</b>	4100 L	18 to 36 m



# 4 LEVELS OF SUSPENSION

## FOR PERFECT STABILITY ON THE ROAD AND IN THE FIELD

Good machine stability while you work is essential to keep the boom as close as possible to the target.

Machine stability is therefore an important prerequisite to achieving this objective. METRIS 2, with its four levels of suspension, allows you to keep your machine stable and perfectly suspended on the road and in the field.



### 1. DRAWBAR SUSPENDED BY PADS

The suspended drawbar protects the tractor and its driver from any machine movements. During transport with the boom folded, all movements are absorbed. You can perform rapid movements in complete safety.



### 2. AXLE SUSPENDED BY PADS

The axle suspended by Strathane pads protects the machine on any uneven terrain, while you work and on the road. A suspended axle means a longer life for your machine!



## KUHN “+” POINTS

### STRATHANE SUSPENSION: DAMPING AND STABILITY

On METRIS 2 sprayers, the drawbar and axle suspension is designed with ultra-reactive pads, made from Strathane. Strathane is used to ensure:

- Rapid absorption of any shocks, without any rebound effects. Strathane absorbs energy without transferring it back!
- Instant adaptation to the load. Whether the machine is full or empty, the pad adapts its damping capacity to prevent any loss of efficiency.
- Low displacement, to keep the machine perfectly stable. One pad on each side to guarantee sprayer stability.



### 3. NITROGEN-BALL PARALLELOGRAM

The parallelogram, for boom height adjustment, is cushioned by nitrogen balls. The boom is suspended during work. In transport position, there are no fixed points linking the boom to the frame. Consequently, the parallelogram is also used for boom suspension. The structure will therefore last longer.

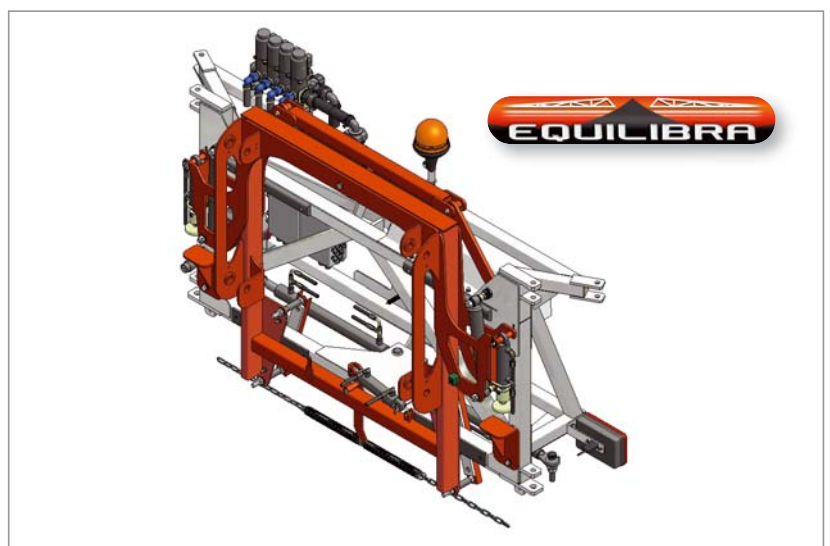

### 4. EQUILIBRA SUSPENSION

EQUILIBRA pendulum link suspension, from 18 to 36 m, provides damping in all three dimensions. It allows the boom to follow the terrain, irrespective of working conditions and without any driver intervention, even at high speed.

# EASY HANDLING

METRIS 2 trailed sprayers are among the most compact sprayers on the market. The hitch to axle distance of 4.40m provides you with easy handling in all situations.

## COMPACTNESS - HANDLING ABILITY

**"With the axle is close to the tractor, the machine cuts out less while maneuvering!"**

*Benoit CHAUVIN – Farmer in Marigny (France)*



## BOOM WITHIN THE MACHINE OUTLINE

With the new aluminium 3-arm boom on METRIS 2 sprayers, the machine structure does not protrude above the tractor cab. With its remarkably short frame, METRIS 2 lets you work where others cannot reach!





# KEEP YOUR SPRAYER WITHIN THE TRACTOR TRACKS

With the steering axle, the sprayer remains within the tractor tracks at the headland, or when cornering in the field. Therefore, crops are protected and your harvest is preserved.



## STEERING AXLE: PRECISE MACHINE MONITORING

The steering axle on METRIS 2 sprayers ensures that the sprayer wheels follow the tractor wheels perfectly. It reacts precisely in response to the speed information received. Steering axle sensors both at the front and rear of the machine are integrated into the sprayer structure - no risk of the information being disturbed by vegetation.

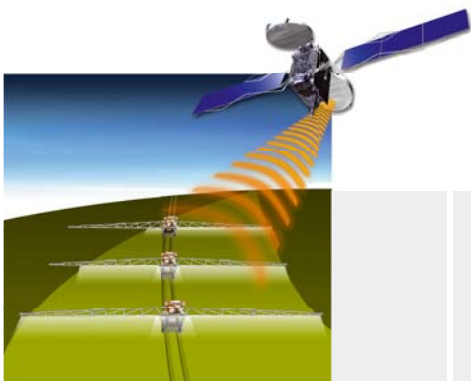

## KUHN “+” POINTS

Used in association with GPS Section Control, the steering axle realigns automatically when reversing: no handling required from the driver!



### TROUBLE-FREE RINSING!

The new 3200 and 4100-litre polyester tanks, manufactured by injection, provide a perfectly smooth surface, both inside and out. As the surface is non-porous, any active matter is easily rinsed to facilitate machine cleaning.

Ideally positioned to prevent any deposits, the machine is easily cleaned using three rotary cleaners. Whether activated from the setting up area or from the cab, tank rinsing is simple and efficient.

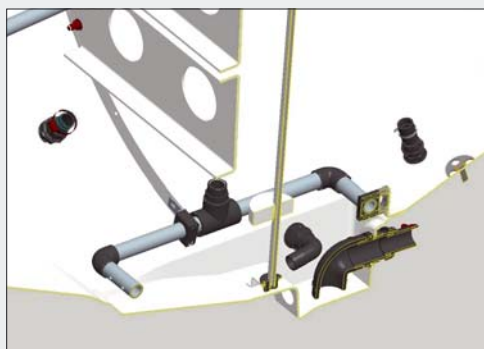

### OPTIMUM TANK DRAINAGE

Located near the sump, the four-dimensional mixing system guarantees a homogenous spraying mixture, without the formation of foam, throughout the spraying process. The sump is extremely deep to provide optimum tank drainage, irrespective of slope in the field.





# CHOOSE HIGH-QUALITY TANKS.

The injected polyester tank design on METRIS 2 sprayers offers a high-quality solution. No expense was spared on materials to provide you with a stable, functional machine.



## MAINTAIN BALANCE!

The injected polyester tank integrates a baffle to stabilise the spraying mixture during transport. Any waves are stopped immediately to maintain sprayer balance.

The central position of the 450 L rinsing tank on the axle allows METRIS 2 sprayers to maintain good balance in any conditions, while reducing any dead storage volumes. The machine's centre de gravity remains central, irrespective of tank level.

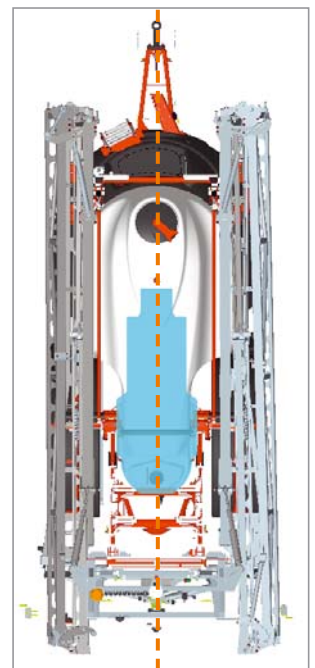

# FILL YOUR SPRAYER EASILY

Filling is strategic on a sprayer. Exact volume, filling time, contact with plant protection products are the usual requirements concerning filling operations. On METRIS 2 sprayers, KUHN has developed a filling design that meets all these requirements.



## MAINTAIN FILLING CONTROL

*Robert HOLMES, farmer  
in Derbyshire (England),  
user of a METRIS 3202 sprayer*

*"Sprayer filling is fully controlled by the EASY-SET unit, with the operator only having to select the required volume of spraying mixture.*

*It is a good system, which helps me a lot. With machine like this, I am ready to carry out spraying work for many years to come."*

**CROP PRODUCTION MAGAZINE May 2015**

DILUSET and e-SET setting up systems integrate a system as standard allowing you to fill the sprayer tank automatically with your selected volume. Plus point of e-Set: no need to climb up into the cab, you just enter your selected volume on the unit in the setting up area!



## VISUALISE THE VOLUME IN THE TANK

You have excellent visibility over the gauges, both from the setting up area and the tractor cab.

The gauge on the rinsing tank also allows you to split up the rinsing operations easily.



## CENTRALISED FILLING

Whether filling the main tank or the rinsing tank, these operations can be performed from the centralised setting up area.

Quick couplings allow you to connect the pipe very easily, without any tools.



## HIGH-VOLUME FILLING

With high-volume piston-diaphragm or centrifugal pumps on METRIS 2 sprayers, you will save time filling the main tank. You can spend less time in the filling area to make the most of your time in the field and increase your work output.



### RAPID INCORPORATION OF ANY PRODUCT

The new chemical induction bowl on METRIS 2 sprayers offers a new reference in terms of safety. Its funnel design allows the efficient integration of all types products, liquids, powders or granules, with reduced times.



### INCORPORATION IN COMPLETE SAFETY

When rinsing on METRIS 2 mounted sprayers, the chemical induction bowl allows you to clean the bottles, the dosage cup or the funnel. With its watertight design and its rotary cleaner, your machine's chemical induction bowl is cleaned efficiently, without any splashing for increased operator safety.





# SIMPLE, BOTH INSIDE AND OUT

Setting up your sprayer is a key stage in the spraying process. With two main valves, the total number of handling operations from filling to rinsing is considerably reduced, any risk of error is eliminated and you can be assured of rinsing all parts of the the sprayer!

Simple setting up also involves a shorter circuit for reduced dead storage volumes, to facilitate the rinsing stages.



## MANUSET

Complete control when preparing your products. During rinsing operations, 360° with the delivery valve ensures that you send clear water into all the sprayer circuits.

## DILUSET +

Rinse your sprayer or boom from the cab!

During filling operations, pumping automatically stops at the required value, while you maintain control in the setting up area with the Diluset + unit.

## E-SET

In addition to the RINS-ASSIST function and the automatic filling system, e-SET guarantees 1:10 dilution of any residues. With the EASYSET unit, no searching for valve positions, just select the required function...





## PREVENT BLOCKAGES, ADOPT QUADRUPLE FILTRATION!

METRIS 2 sprayers are equipped with four levels of filtration. After filling (1), the suction filter (2) and the delivery filter under pressure (3) will prevent any larger impurities from reaching the boom.

Bowl filters on the boom (4), positioned after the section valves, as close as possible to the nozzle, will keep any blockages down to a minimum.

All filters can be cleaned, even when the sprayer tank is full.

With a single circuit, you are fully in control of any actions you may carry out with your sprayer. With METRIS 2 sprayers, imagine what you are doing before you even touch any valves!

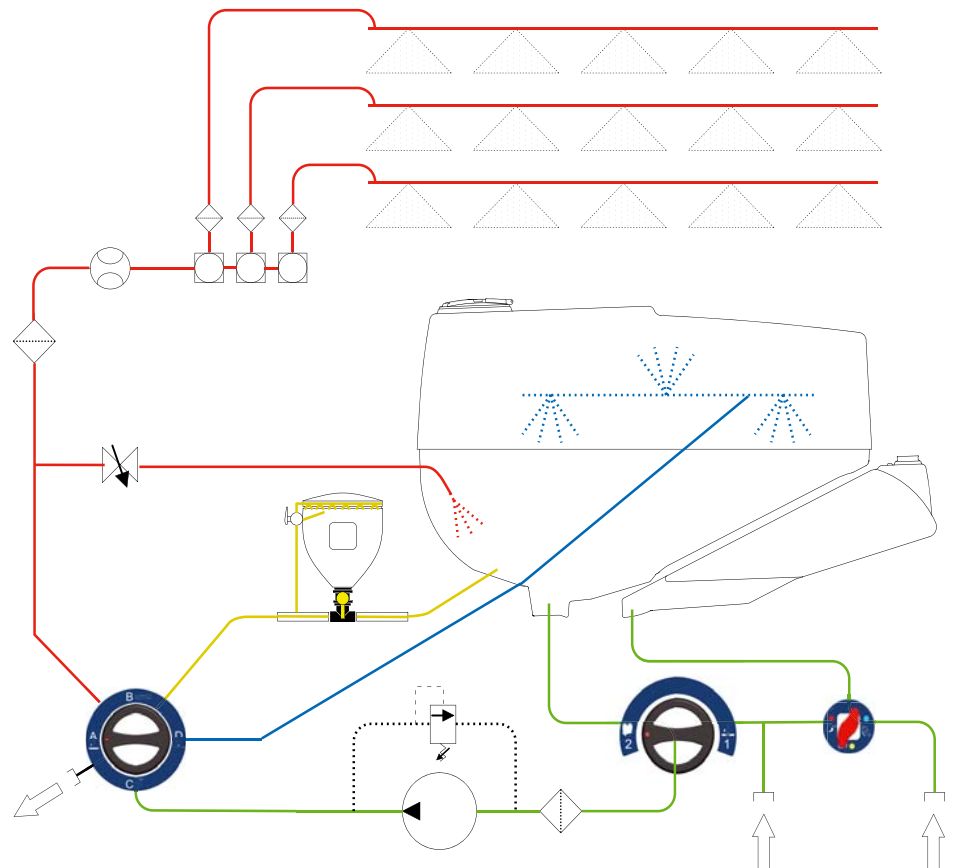

## KUHN “+” POINTS

360° FOR 30% LESS HANDLING

The multi-function handwheel allows you to rinse the entire sprayer with one hand

= You save time during the setting up process. You reduce the number of handling operations by up to 30% compared to some competitors, providing trouble-free setting up of the machine.



# SAVE TIME, FASTER SPRAYING

## ESSENTIAL 3D SUSPENSION!

EQUILIBRA pendulum link suspension provides boom damping in all 3 dimensions. Even when spraying on uneven terrain, EQUILIBRA keeps the boom parallel to the ground. No more impacts on the ground or crops, nor excessive boom movements that increase drift!

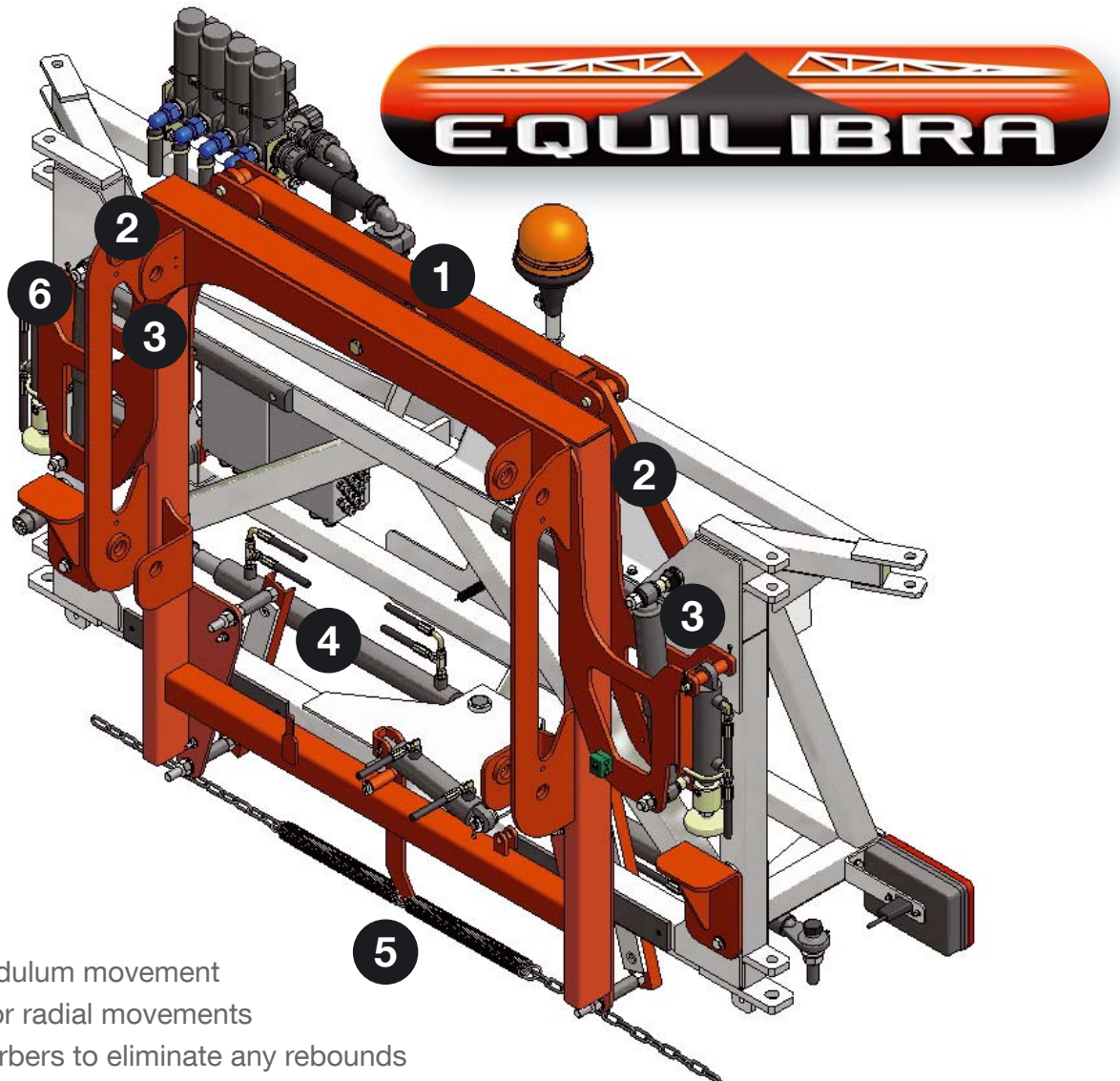

- ❶ Robust pendulum movement
- ❷ Link rods, for radial movements
- ❸ Shock absorbers to eliminate any rebounds
- ❹ Independent Left/Right anti-whiplash
- ❺ Spring-loaded automatic tilt corrector
- ❻ Frame locking



### **EQUILIBRA: PENDULUM LINK SUSPENSION WITH SHOCK ABSORBERS**

On uneven terrain, the combination of a pendulum and link rods offers sufficient freedom of movement to maintain boom stability, irrespective of the type of land constraints encountered.

two shock absorbers are also used to dampen and limit any vertical movements to keep the boom perfectly level, especially when cornering, even at high speed.



### **INDEPENDENT ANTI-WHIPLASH: THE 3<sup>rd</sup> DIMENSION**

Whiplash describes back-and-forth boom movements which are highly damaging to the joints, especially during headland manoeuvres: Braking (1), Cornering at the headland (2), Acceleration (3). The system with a nitrogen ball on the cylinders of the first arms provides full and independent protection on each side of the boom in all situations for increased reliability, as well as during all spraying phases.

The structure is therefore protected, even under heavy braking.

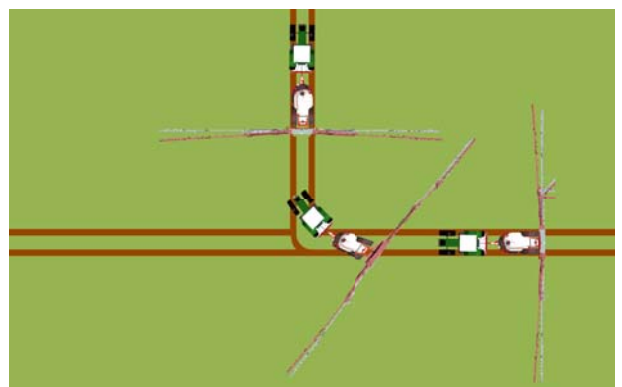

### **AUTOMATIC MECHANICAL TILT CORRECTION**

The springs located under the lower part of the frame allow the boom to follow the terrain automatically. This tilt correction remains fully mechanical, with no action required from the driver.

- A hydraulic tilt correction cylinder supplements automatic mechanical correction in particularly hilly areas.
- Shock absorbers on each side of the frame limit boom inertia and reduce any lateral movements of the structure.



# THE POWER OF ALUMINIUM: Opt for a light-weight and durable solution!

With a density 3 times lower than steel, aluminium booms provide a low-weight machine, whilst retaining a structure that protects the sprayer parts. The low-weight of the booms makes it possible to respect the soil structure, even when working in wet conditions.

Aluminium boom production provides outstanding strength. Aluminium is completely resistant to corrosion and aggressive chemicals, requires no protection and significantly facilitates sprayer servicing and long life.

## RHPA 12/24 m 7 sections

Other widths available  
12 / 18 m  
12 / 21 m  
14 / 27 m  
14 / 28 m  
14 / 27 / 28 m

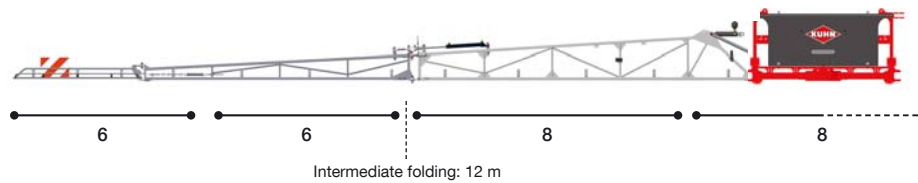

## TR4 15/28 m 7 sections

Other widths available  
12 / 24 m  
15 / 27 m  
15 / 27 / 28 m  
16 / 30 m  
16 / 28 / 30 m

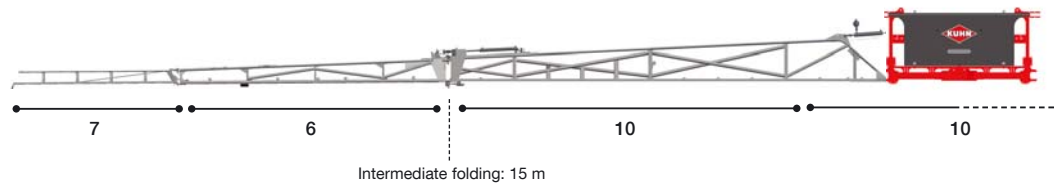

## RHA3 24/36 m 9 sections

Other widths available  
22 / 28 m  
24 / 30 m  
24 / 32 m  
24 / 33 m  
24 / 32 / 33 m

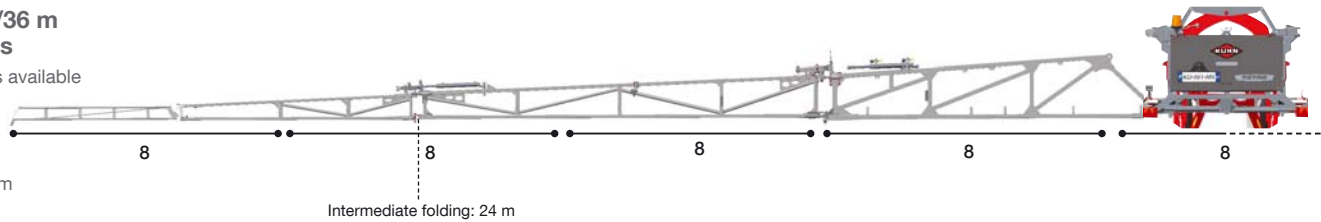



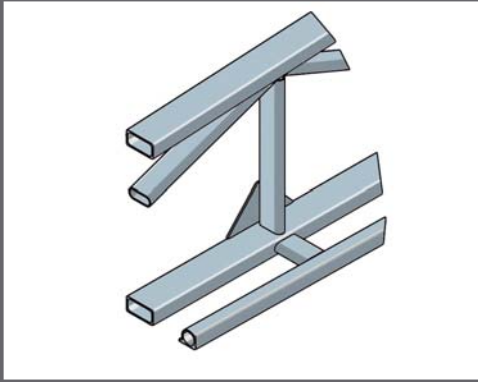

### RHPA: 18 TO 28 M

This boom has a light-weight aluminium structure. The jets are integrated into the boom on the first arm and protected on the front side on the second arm.

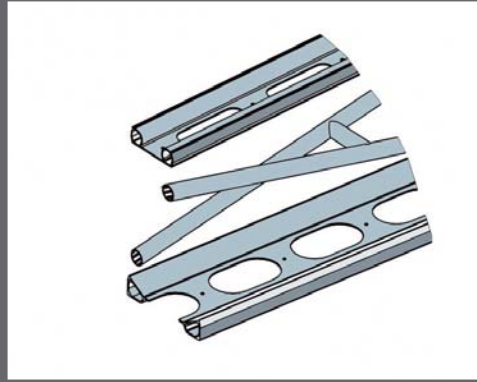

### TR4: 24 TO 30 M

The boom has a tubular structure and the profile forms an integral part of the boom for greater robustness and full jet protection.

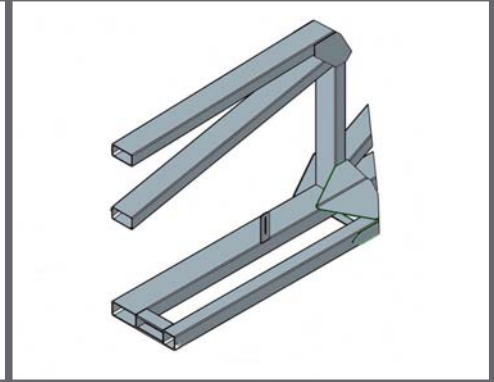

### RHA3: 28 TO 36 M

This range is only available as a three-arm boom and is fully integrated within the machine outline. The boom can open out to an intermediate length of 24 m to adapt to various requirements. The nozzles are integrated into the whole boom structure.

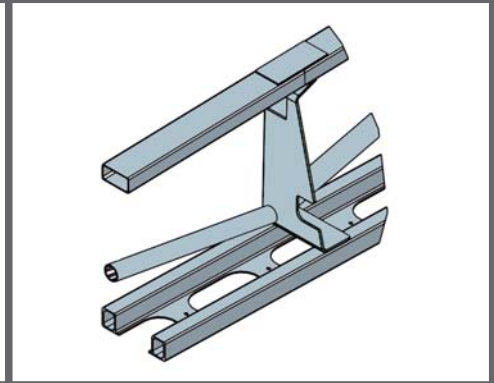
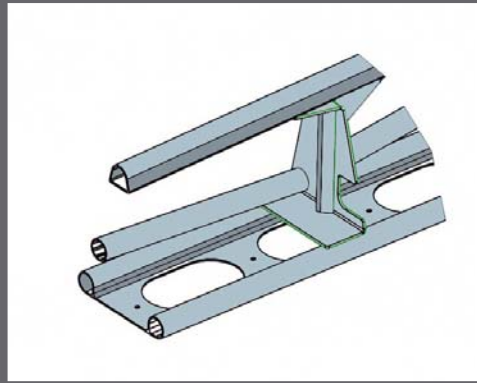
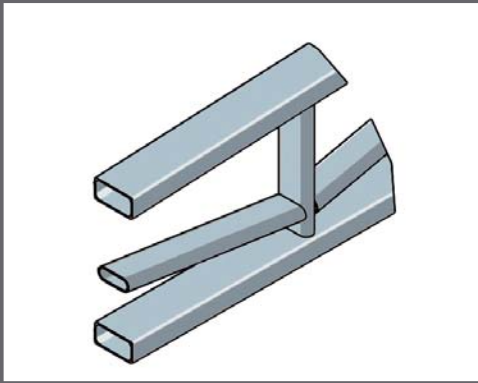

# DO NOT OVERLOOK ANY DETAIL

KUHN are designed to be fully suited to your usage. All aspects, such as the protection of vital components, the long life of the structure or the adaptation of the machine to your conditions, have been closely studied during the machine design phase.



## LARGE-SIZED JOINTS

The joints are ball-mounted to allow them to swivel without any stress on the structure, and to ensure long life for the boom. The size of the joints allows the boom to last longer, with minimal servicing.



## PIPE INTEGRATED WITHIN THE STRUCTURE

The boom-end safety devices can be moved in all three dimensions.

Integrated within the structure, the pipe and jets are protected from the front, underneath and from the rear. There is no risk for the boom, even in the event of rubbing.



## STAINLESS STEEL PIPES AND PIPE ADJUSTMENT

The stainless steel pipe guarantees long life and resistance to any changes in temperature. The height adjustment of the pipe assembly means that the jets are constantly protected by the boom structure, irrespective of your nozzle type.





# CONTROL THE BOOM WITH YOUR FINGERTIPS!

During opening/closing operations, it is essential to be able to control the right function, at the right time.

The CH10 unit has been designed to provide easy access to the functions that you need, when you need them.

## CH10 UNIT: ADAPTED TO ALL CONFIGURATIONS

The CH10 unit comprises all the elements required for sprayer handling, irrespective of any optional equipment. Variable geometry? Steering axle? All elements are provided to control the machine with your fingertips!

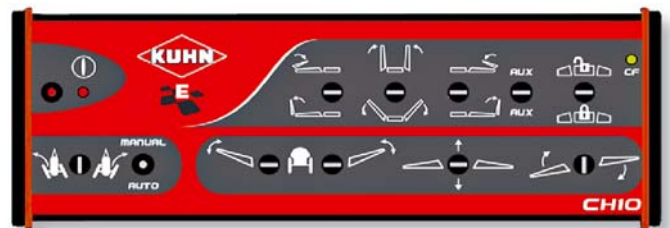

## ONLY ONE FUNCTION PER BUTTON

With one function per button, the CH10 unit provides easy handling of all boom functions at all times. Functions are clearly identified by a suitable logo. The CH10 unit is connected to the regulation unit and requires no additional connections, it is directly integrated near the regulation unit.



## FUNCTION SELECTOR: THE COST-SAVING SOLUTION

For a machine with simple folding kinematics, the hydraulic function selector provides you with an even simpler solution, and just as easy to use.

While a single-acting valve is used to control boom height, a double-acting valve controls boom opening/closing, and tilt correction.

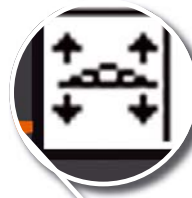



# ACCURACY FROM THE START TO THE END OF YOUR WORK! PNEUMATIC CONTINUOUS CIRCULATION

Product circulation through the boom affects the quality of your spraying in many ways: Priming, nozzle opening and closing responsiveness, reduced blockages, etc.  
With pneumatic continuous circulation, KUHN offers you improved spraying quality.

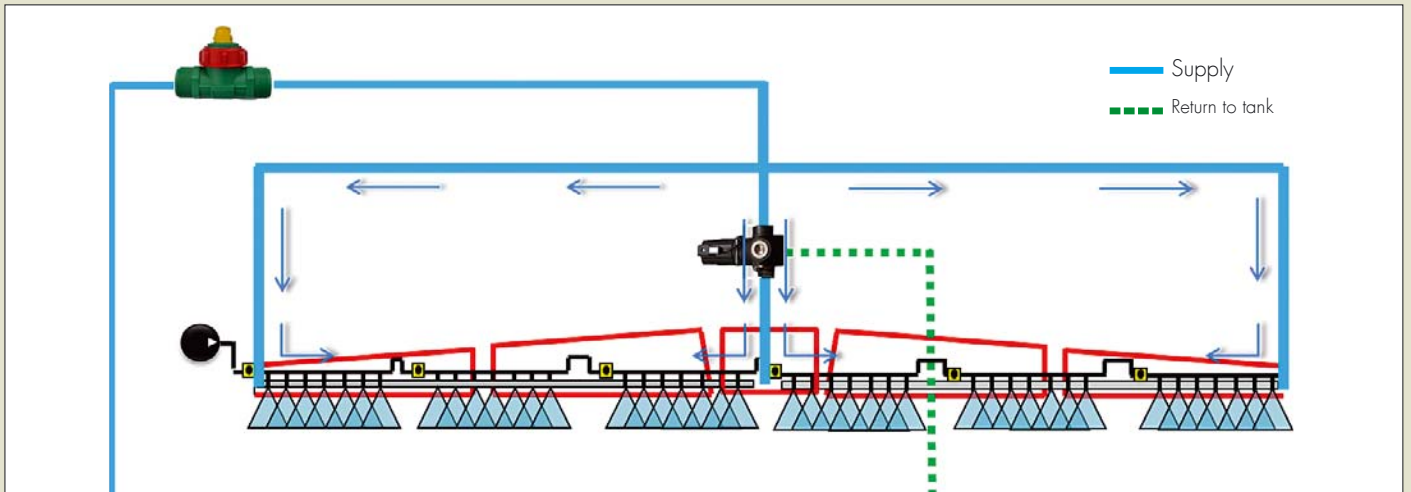

## INCREASE YOUR SPRAYING ACCURACY:

### PNEUMATIC CONTINUOUS CIRCULATION

- Accuracy when you start work in the field: even when spraying stops, product flows continuously through the boom. Priming is continuous and the risk of deposits is very low. The boom is already primed before you even reach the field!
- Opening and closing accuracy: an air circuit controls the anti-drip valves directly and the spray opens and closes instantly. With ultra-fast closing, reinforce the cost-effectiveness of your GPS cutout!
- Reduced blockages: product circulates through the boom continuously, eliminating any risk of deposits or of accumulation at the section ends.



# LET THE SYSTEM CONTROL THE BOOM, BOTH DURING DAYLIGHT AND AT NIGHT! BOOM ASSIST HEIGHT ASSISTANCE

Correctly controlled spraying height is essential to maintain good distribution while limiting drift. In specific topographic situations, BOOM ASSIST will help you control the boom, in particular at night, when conditions are ideal.



## **BOOM ASSIST: BOOM AT THE CORRECT HEIGHT MEANS LIMITED DRIFT AND COST-SAVINGS**

BOOM ASSIST keeps the boom at the correct height, irrespective of field topology. Keeping your boom at the ideal height limits drift (wastage) and provides savings in terms of crop protection products! Using ultra-sound sensors, the system detects the boom height at all points. Ultrasound technology is used to maintain the correct boom height in relation to the vegetation, under any conditions: day or night, dry weather or fog, vegetation or bare ground, BOOM ASSIST automatically adjusts the height, tilt and independent variable geometries to keep the boom close to the target. While you drive the tractor without having to steer the boom, BOOM ASSIST controls the hydraulic boom functions.

## **KUHN “+” POINTS**

Sensors are specially designed for spraying, allowing you to monitor the ground, the crops, or both at the same time in hybrid mode. The patented HYBRID mode is integrated as standard into the sensors and enables the system to detect crop height. For uneven or flattened crops (Potatoes, Rape, etc.), the system never loses its efficiency.



## **H-MATIC AUTOMATIC BOOM LIFTING**

At the headland, when spraying stops, the boom height is increased by a value preset by the user. Headland manoeuvres are facilitated, with increased speed. While you work, the unit indicates the height of the centre frame. In transport position, a lower stop can be set. With GPS Section Control, the automatic H MATIC lifting system will anticipate boom lowering to ensure the correct height when the first section opens!





## ESSENTIAL FOR SPRAYING ACCURACY REB3 UNIT

The REB3 unit groups together all sprayer functions. Adapted to crop protection work, it was designed to be as easy to use as possible, with good ergonomics.



### EVERYTHING IS SIMPLY BUILT-IN.

DPAE regulation is used to accurately control the dose applied.

With the REB3 unit, you are assured of putting the right product, in the right place!

Menu browsing is easy, readable and highly ergonomic.

### EVERYTHING IS SIMPLY BUILT-IN. .

The REB3 regulation unit provides the following functions:

- DPAE regulation
- Sequential section opening/closing
- Control of the various electrical equipment (headlights, revolving light, etc.)
- Automatic filling control
- Boom folding and hydraulic tilt
- H-MATIC: boom height at the headland
- GPS Section Control
- Control of boom-end jets
- Rinsing controlled from the cab

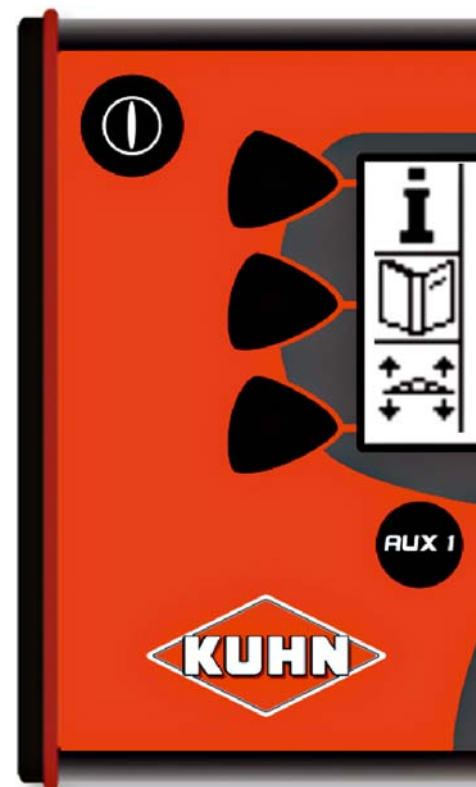

## KUHN “+” POINTS

Keep an eye on information that is important to you while you work. Very easy to read and clearly displayed in large letters.

The following information is displayed on a single working screen:

- Dose applied, and selected
- Theoretical pressure
- Forward speed

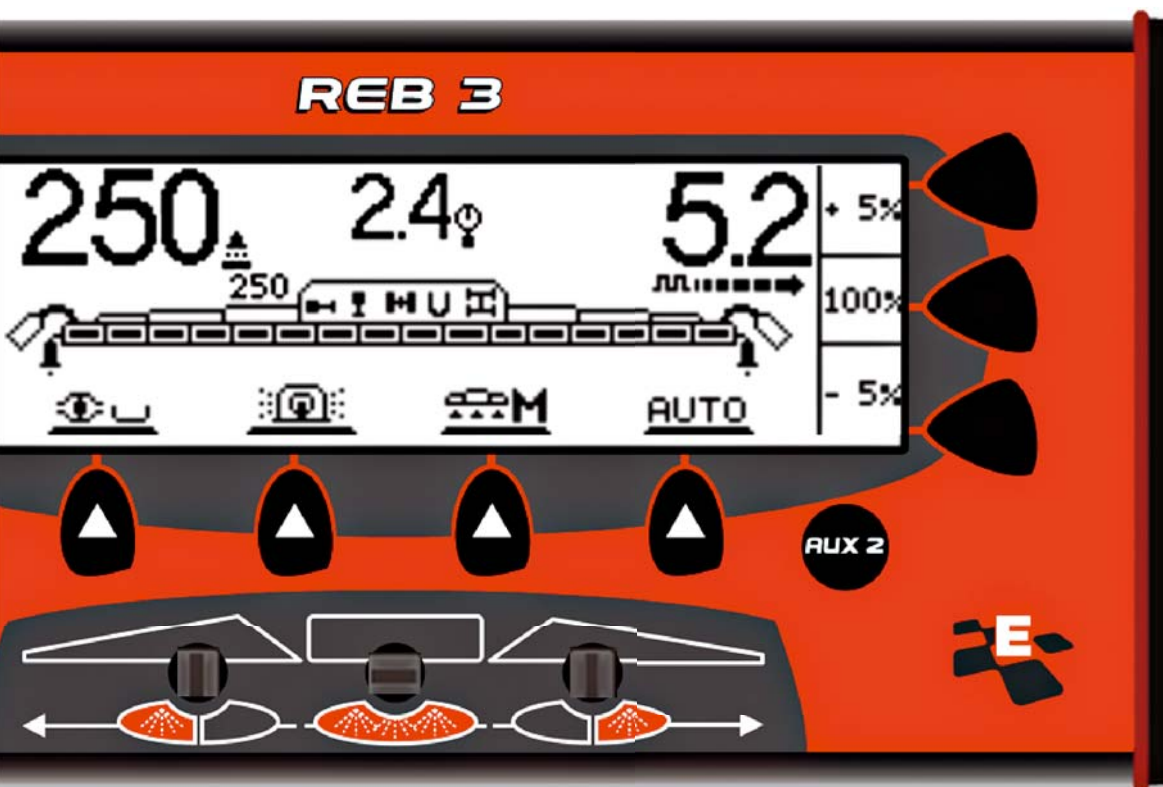

REB3 unit at scale 1:1

### OUTSTANDING COMPACTNESS

With its compact dimensions (21.5 x 11 x 4.5 cm), the REB3 unit is easy to install in any cab.

Moreover, its small BUSCAN harness, comprising only 5 wires, is easy to connect and will not prevent the rear tractor window from opening.



# MAKE SPRAYING SIMPLER WITH VISOIREB

Automatic section cutout is becoming the standard, both for application accuracy and for your comfort. Designed around the GPS Section Control function with a 7-inch touchpad, the VISOIREB regulation unit is perfectly adapted to spraying.

Whether preparing, spraying or visualising, the VISOIREB terminal facilitates spraying in all stages of your work.



## OUTSTANDING ERGONOMICS!

With its latest generation colour touch screen, the VISOIREB terminal provides outstanding ergonomics.

With its uncluttered and intuitive menus, you can prepare your sprayer in just a few clicks.

From controlled sprayer filling to nozzle selection, the VISOIREB unit will only ask you the questions required to perform high-quality work in your selected field.



## KUHN “+” POINTS

### MONITOR YOUR WORK WITH VISUALISATION

Modify the view angle for your field, as required!  
Rear view, top view or automatic mode? Anything is possible!  
You can even move the machine manually.

At the headland, the zoom enables you to check that all hidden areas of your field have been treated





## ITS MANY FUNCTIONS

In addition to controlling the functions integrated into the REB3 unit, the VISOIREB terminal offers you the following points as standard:

- Assisted filling, with a built-in computer
- Contrast that automatically adapts to the working conditions
- A visual aid to ensure that the entire field has been treated
- Increased intuitive operation via visual indicators
- Facilitated field management, providing improved traceability

## IT ONLY DISPLAYS WHAT YOU NEED, WHEN YOU NEED IT!

Dose applied, pressure, speed, volume remaining in the tank or, alternatively, section control?

It's all there, and nothing else. Functions are displayed when you click or at the headland to let you control the options as required.

VISOIREB will not drown you in unwanted information and lets you only display what you need, while you work.



VISOIREB unit in 1:1 scale, while spraying



# GPS SECTION CONTROL: SIMPLY HIGH-PERFORMANCE

Boom sections open and close automatically. Fully integrated into the REB3 or VISIOREB regulation unit, the configurable system is simple to manage according to requirements.

Work during daylight or at night without fatigue and with the same efficiency:

- No additional boxes or wires
- Only 3 operating modes (manual, contour or automatic)
- Various configurations can be programmed to optimise overlap



**IMAGE TITLE: THEY'RE TALKING ABOUT IT! – MAGAZINE TOP AGRAR FROM MARCH 2014 "SPRITZENVERGLEICH: SAUBER UND GENAU"**

According to tests carried out by German magazine Top Agrar with the JKI institute (Germany), METRIS 2 sprayers with GPS Section Control cut out extremely accurately, as close to the ideal point as possible, whether at 8 or 16 km/hr.

From Topagrar magazine from March 2014 in its article "Spritzenvergleich: sauber und genau", "The GPS cutouts operated correctly during the tests, any differences in cutout with respect to the ideal point were relatively insignificant"

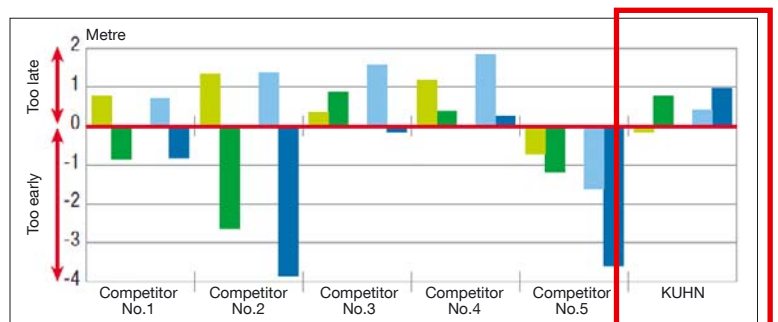
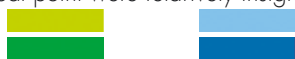

## KUHN “+” POINTS

Optional equipment is coupled to the GPS Section Control:

- H MATIC: when the spray opens, the boom is already at spraying height.
- STEERING AXLE: when reversing, the axle realigns itself and lets you regain control if you wish to steer it.



# BECOME A PRECISION FARMER

Precision farming facilitates the optimisation of supplies and output, while preserving resources. The concept takes into account any variations in crop growth or soil nutrients in the field, and is based on state-of-the-art-technology, such as geolocation tools (GPS).

## MODULATE THE DOSE – MODULATION MAPS

To reduce your production costs, dose modulation is now possible between fields. Integrating a recommendation map into your GPS will allow the regulation unit to apply the selected value directly.

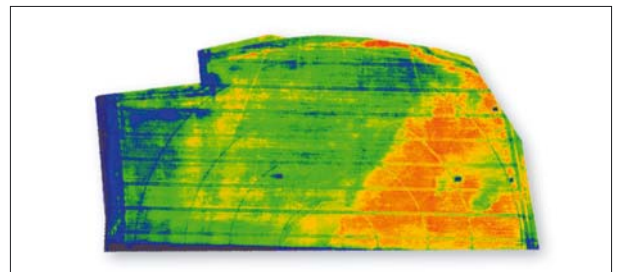

## MODULATE THE DOSE – N-SENSOR

The regulation unit is compatible with many nitrogen sensors.

You only apply products that the plant needs, without any excess! You can then use all the potential of your soil.



## ALREADY EQUIPPED WITH A GUIDE BAR?

Compatibilities exist with many guide bars equipped with GPS section cutouts. Cutouts such as Trimble, CNH, Raven, Top Con, Teejet, Arag or Rinex are compatible.

This is your opportunity to increase the benefits from the equipment on your tractor. A simple interface will make the REB3 compatible with your section cutout.



## KUHN “+” POINTS FOR QUALITY SPRAYING



### PROTECT THE EQUIPMENT ON YOUR SPRAYER

The protective covers proposed with METRIS 2 trailed sprayers integrate all the machine components. Centralised filtration, valve panel, incorporator... everything is protected from any projections or tall crops.



### CONTROL THE BOOM-END JETS FROM THE CAB

For increased spraying width, an additional asymmetric jet can be installed on the boom-ends. These nozzles are controlled electrically from the cab. Limited to one side of the boom, or on both sides, these nozzles will be beneficial when working with different tramline spacings or when treating your field borders.



### CONVENIENTLY LOCATED STORAGE FOR YOUR PROTECTIVE EQUIPMENT

The watertight, partitioned locker on METRIS 2 can be used to store all your equipment in a simple, orderly manner. Accessible from the sprayer setting up area, your gloves, mask and glasses are conveniently stowed away... or, alternatively, the unit when the machine is uncoupled



### WORK WITH TWO BOOM WIDTHS ON THE SAME MACHINE!

On some boom widths, it can sometimes be beneficial to combine two boom widths, either when working on crops with different spacings, or to anticipate any future sowing tool replacements. The boom is equipped with a modular end-fitting suited to your needs.

# EVER-USEFUL EQUIPMENT



## CHOOSE THE COUPLING METHOD CORRESPONDING TO YOUR TRACTOR

High or low coupling, with various eye bolt diameters or ball hitch, MÉTRIS 2 sprayers allow you to choose a machine suited to your tractor. KUHN offers a huge range to ensure the perfect connection between your tractor and the sprayer.



## NOZZLE: A KEY PLAYER IN QUALITY SPRAYING!

Using the most suited nozzle for your application is essential! Volumes applied, hygrometry, wind, Kuhn can advise you on how to choose the most suitable nozzle for your conditions. A Smartphone application is available free of charge. [...] available free of charge in the store corresponding to your smartphone.



*Scan it and download it.*

## WORK IN OPTIMUM CONDITIONS: WORK LIGHTS

To allow you to work in optimum spraying conditions (low temperature and high hygrometry), night work is possible. LED lamps are positioned under the boom on each side for perfect spraying control, even at night.



## THINK OUTSIDE...

Rinse the outside of the machine with the exterior cleaning kit (automatic 1.5 m hose reel and spot spray gun). By cleaning the machine in the field, the machine returns to the farm ready for use with a different product.



## Technical specifications

### METRIS 2

Boom type	RHPA	TR4	RHA3
Tank capacity	3200 or 4100 L		
Actual capacity	3430 or 4380 L		
Rinsing tank capacity	450 L		
Boom width	18 to 28 m	24 to 30 m	28 to 36 m
Regulation	DPAE, REB3 or VISIOREB		
Pumps	PM 265, PM 320, PM 500 or PC 700		
Setting up	MANUSET, DILUSET + or e-SET		
Stand for removal	Manual or hydraulic		
Suspension	Quadruple (drawbar, axle, parallelogram and boom)		
Boom suspension	EQUILIBRA (Pendulum links with independent L/R anti-whiplash)		
Filtration	Quadruple (on filling, on suction, before flowmeter and per section)		
Hitch to axle length	4.40 m		
Tracks	Adjustable from 1.50 m to 2.25 m (depending on tyres)		
Overall width	2.55 m		
Transport height	3.20 (24 m)	4.00 (28 m)	3.55 m
Nozzle height	0.50 m to 2.25 m (tyres 18.4 x 38)		
Unladen weight	2800 (24 m)	3460 (28 m)	4050 (36 m)



be strong, be **KUHN**

## KUHN PARTS

DESIGNED AND MANUFACTURED  
TO RIVAL TIME



KUHN foundries and forge as well as a high-level manufacturing process allow the production of spare parts to defy time. You can truly rely on our know-how and our genuine parts. Farmers benefit from our client support and logistics services via any KUHN PARTS warehouse, which provide quick and reliable repair solutions in cooperation with your nearest authorized KUHN dealer.



\* KUHN SERVICES:

# MAXIMISE THE USAGE AND PRODUCTIVITY OF YOUR KUHN EQUIPMENT

\*Some services are not available in all countries.

## KUHN sos order

### With Kuhn SOS order, receive your parts all year round\*

Need spare parts quickly? With KUHN sos order, we offer express delivery 7 days a week, 362 days a year. Reduce your machine downtime and improve your work output.

\* except for 1st January, 1st May and 25th December.

## KUHN i tech

### For ever-faster repairs!

An unexpected technical hitch always occurs at the wrong time. Thanks to KUHN i tech, your KUHN Approved Partner can get you up and running again quickly and efficiently. This tool is available online 24/7 for a quick and detailed diagnosis.

## KUHN protect +

### The professionals' choice!

Benefit from 36 months of trouble-free use with the KUHN protect+ warranty. You can concentrate fully on your job and the performance of your machine. That is exactly what you expect when invest in high-tech machinery.

## KUHN finance

### Invest wisely!

Need a new machine, but unsure how to finance it? Modernise your pool of machinery and improve your farming business with KUHN finance - in complete safety and in tune with your needs and requirements. We offer finance solutions tailored to your needs.



LEXIS

METRIS 2

OCEANIS

# KUHN TRAILED SPRAYERS IN BRIEF

## Technical specifications

	LEXIS	METRIS 2	OCEANIS
Tank capacity (L)	3,000	3200 - 4100	5600/6500/7700
Boom width (m)	18 to 24	18 to 36	24 to 48
Regulation unit	RPB - REB3 - VISOIREB	REB3 - VISOIREB	REB3 - VISOIREB
Drawbar suspension	-	◆	◆
Axle suspension	-	◆	◆
Boom suspension	TRAPEZIA / EQUILIBRA	EQUILIBRA	EQUILIBRA
Steering drawbar	◇	-	-
Tag axle	◇	◇	◇
Boom circulation	Standard - Boom-end	Standard - Boom-end - Continuous	

◆ standard equipment

◇ optional equipment

- unavailable

## LEXIS



## METRIS 2



## OCEANIS



For more information about your nearest  
KUHN dealer, visit our website  
[www.kuhn.com](http://www.kuhn.com)

**KUHN BLANCHARD SAS**

24 rue de Nantes - 44680 CHÉMÉRÉ - FRANCE

**KUHN NORTH AMERICA, INC.**

1501 West Seventh Avenue - P.O. BOX 0167 - Brodhead, WI 53520 - USA

**KUHN FARM MACHINERY PTY. LTD**

313-325 Foleys Road - Deer Park, VIC, 3023 - AUSTRALIA

**KUHN FARM MACHINERY (U.K.) LTD**

Stafford Park 7 - GB TELFORD/ SHROPS TF3 3BQ



Visit us  
on our YouTube channels.

[www.kuhn.com](http://www.kuhn.com)

Your KUHN dealer

Information given in this document is only for information purposes and is non-contractual. Our machines are in compliance with regulations in force in the country of delivery. In our literature, and for improved illustration of certain details, some safety devices may not be in operating position. When operating these machines, these devices must be in position in accordance with the requirements indicated in the operator's manuals and assembly manuals. Respect the tractor gross vehicle weight rating, its lift capacity and maximum load per axle and tyres. The tractor front axle load must always comply with the regulations of the country of delivery (In Europe, it must reach minimum 20 % of the tractor net weight). We reserve the right to change any designs, specifications or materials listed without further notice. Machines and equipment in this document can be covered by at least one patent and/or registered design. Trademarks cited in this document may be registered in one or several countries.

You will also find  
KUHN on

